

70

ALUMINIUM EXTERNAL FRENCH DOOR PAIRS

Assembly Instructions

1.2M - 1190mm W x 2090mm H

1.5M - 1490mm W x 2090mm H

1.8M - 1790mm W x 2090mm H

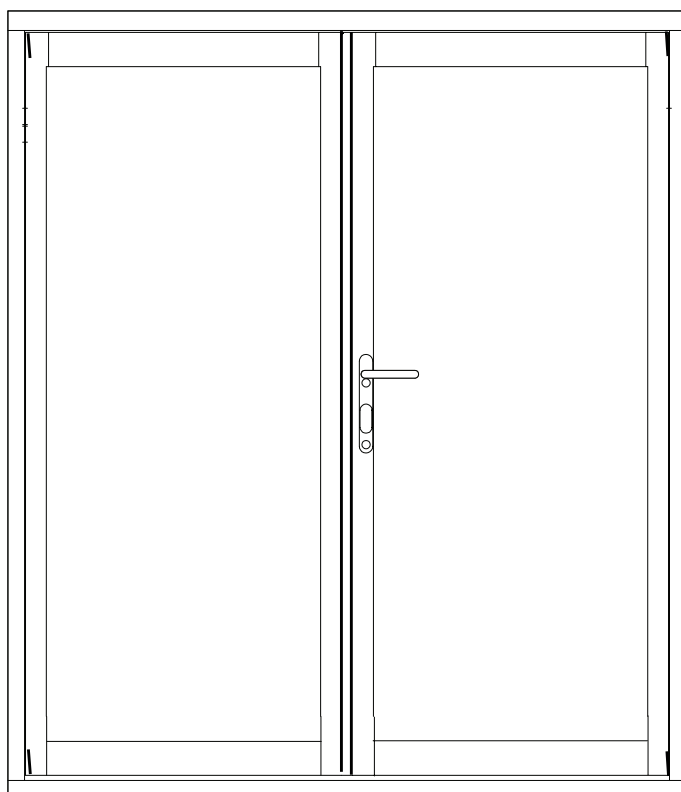

About your Aluminium French Door Pairs

All products must be installed in accordance with accepted good trade practise (and in accordance with supplied instructions where applicable), and maintained in accordance with these procedures or else the warranty shall be void.

Important information

- We recommend that a competent tradesperson installs this product
- A single person must NEVER carry out the installation, as some components are very heavy

Automatic closures and operators

- The hardware systems are designed for manual operation. Poorly Adjusted automatic closures can impart significant destructive forces to tracks, bearings and stops. Such hardware used in installations is expressly excluded from warranty terms.

Care of doors and frames on site

- Please check doors, frames and cill at the time of delivery and within 72 hours of delivery to ensure that they are acceptable and in good condition. If you find a component missing or damaged, please inform your supplier immediately. We keep replacement components of most set parts and these can be sent out to you quickly. This will save you having to repackage and return the whole set, and allows you to continue with the project. (See contents list on page 3 for full list).
- When storing prior to installation, the doors and frames should be handled with care and stored in a dry, ventilated building. Doors and frames should be stored flat and on a level surface (not on edge or on end).
- Should you need to store the doors before installation, they must still be fully inspected and checked for damage or faults and reported within 72 hours of delivery, repacking if necessary.
- Doors should not be stored or fitted in the building until the wet trades such as plastering, painting etc. have been completed and the room is dried out.
- Remove the blue plastic protective film immediately after installation. We do not recommend to leave this on for long periods of time as moisture can get trapped underneath the film, causing permanent marks on the aluminium powder coating.
- Do not leave masking tape on the aluminium powder coating for long periods of time. It is important it is removed within 24 hours of applying.

Trimming

- This bi-fold door is not designed to be trimmed on site and should be fitted as supplied. Trimming the doors or frame will void the warranty.

Conditions of sale

- We shall not be held responsible for any incidental work expenses arising out of or because of any defects in our product, or bad workmanship to our product. In the event of goods having manufacturing defects and requiring replacement, our liability will be limited to the value of the door or frame component only. These notes do not affect your statutory rights with the retailer of this product.

Maintenance

The aluminium powder coating and bi-fold door hardware in buildings are subject to deterioration from everyday use, and also environmental attack due to atmospheric and other conditions. Maintenance of the powder coating and hardware is even more important in severe environments such as close to marine areas, and some industrial areas. Even stainless steel products require maintenance to prevent deterioration in some environments. We require the following minimum maintenance to be followed otherwise the warranty shall be void.

Hangers, pivots and brackets

A light spray application of a suitable lubricant such as WD40, followed by a light wipe with a dry cloth to remove excess, is recommended to all hinges, pivots and brackets. Exposed surfaces should first be wiped with warm soapy water and a soft rag, and then rinsed clean before applying preventative.

Hinges

Wipe down the visible surfaces with warm soapy water on a soft rag and then rinse off by wiping with a clean damp rag. Application of a thin film of a light machine oil or WD40 will help maintain the original lustre of the metal finish.

Twin point locks

Spray application of a suitable lubricant such as WD40 to the sliding pin inside the bolt and to the lock cylinder is recommended. A tube attached to the nozzle will help concentrate the spray where you want it to go. There are access holes or slots on all twin point locks, so that this can be done without removing the locks from the doors.

Frequency

The procedures mentioned above need to be carried out as often as is necessary to prevent deterioration in the installed environment, however we recommend the following minimum frequency of application;

General environment	- 6 monthly
Close to marine environment	- 3 monthly

Aluminium powder coating

Preferably, every time you clean your windows also clean the aluminium doors and frames, or at the minimum every 3 months (or monthly if within 5 miles of the sea, or industrial areas.) Wash the outside of the doors and frames with soapy water using a mild detergent and soft lint free cloth. Dry the surface using a clean absorbent cloth or leather, then buff with a soft cloth.

Contents

Please check the contents of the packages to ensure that all parts are present before beginning assembly

Aluminium Parts

Doors

Door with Lock Keep	Quantity 1
Door with Lock	Quantity 1

Frame Pack

Frame Head-	Quantity 1
Frame Jambs –	Quantity 2 (1x left and 1x right)
Frame Cill –	Quantity 1

HARDWARE.

Concealed top pivot
Quantity 2

Concealed bottom pivot
Quantity 2

Twinpoint lock handle set
Quantity 1 set

Left and right gasket head/jamb
Quantity 1 pair

Plastic cill end caps
Quantity 1 pair

Eurocylinder with keys
Quantity 1

Top and bottom Lock Keep
Quantity - 2

Centre lock keep
with latch plate
Quantity - 1

Handles
Quantity - 1 pair

MPL Lock - Quantity 1

Installation Kit

- (A) Direct fix screws 92mm - Quantity 12
- (B) Direct fix screws 72mm - Quantity 6
- (C) SDS Masonry drill 6.5 x 210mm - Quantity 1
- (D) Torx long driver bit 70mm x T20 - Quantity 1
- (E) Torx long driver bit 70mm x T30 - Quantity 1
- (F) Torx long driver bit x T15 - Quantity 1
- (G) Frame fixing screws 50mm - Quantity 12
- (H) Cill end cap screws 8mm - Quantity 6
- (I) Plastic frame fixing covers- Quantity 20
- Assorted packers and wedges - Quantity 1 bag

VERY IMPORTANT NOTE

- To speed installation;
- The Lock door MPL, twinpoint lock and twinpoint lock handles are already installed into the doors
 - The centre door keeps are already installed into the door
 - The bottom pivot hinge is fixed to both doors.
 - The two bottom pivot blocks are fixed into the cill and the top pivot blocks into the head.

Preparing the site

Brickwork opening width = Frame width + 10mm



Brickwork opening height
= Frame height + 10mm

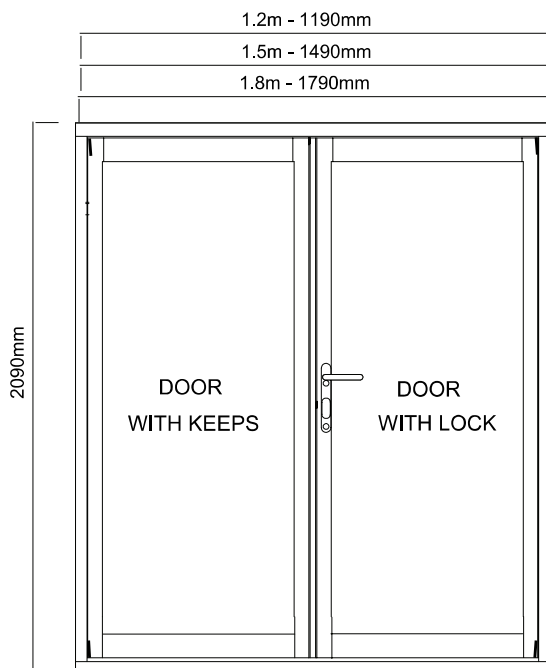
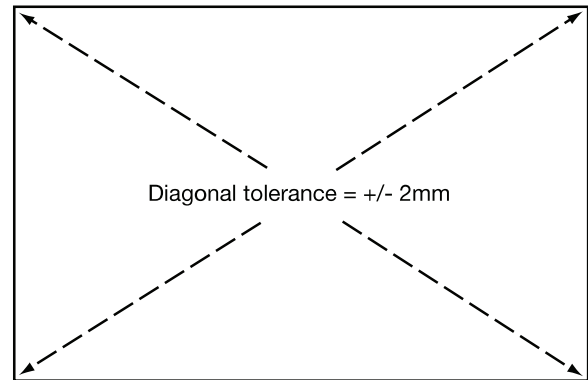

Brickwork opening:

When preparing the site, please prepare the brickwork opening to be 10mm more in height and width than the outside assembled frame size.

It is essential that all 4 internal surfaces of the brickwork be levelled before installation. Please ensure that all dimensions are correct for installation before proceeding, as the set must be installed square and level into the opening.

The Aluminium French Door assembled outer frame sizes are as follows:

1.2m = 1190mm Wide x 2090mm High

1.5m = 1490mm Wide x 2090mm High

1.8m = 1790mm Wide x 2090mm High

The recommended Brickwork opening sizes are as follows:

1.2m = 1200mm Wide x 2100mm High

1.5m = 1500mm Wide x 2100mm High

1.8m = 1800mm Wide x 2100mm High

Assembling the frame

1.a.) Fix the self adhesive foam gasket to the left and right jamb, adjacent to the frame head.

1.b.) Apply a thin bead of silicone sealant to the ends of the frame jambs which fix to the Cill

Note: We recommend you keep the protective film in place until the frame is assembled, and installed.

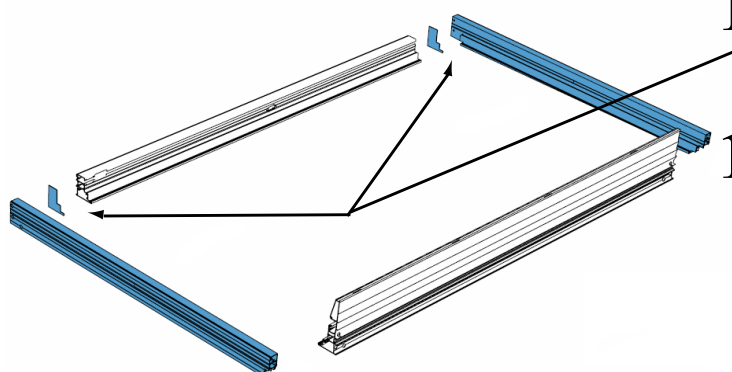

2 Assemble the complete frame by fixing the jambs to the head and cill using the 50mm frame fixing screws (G) provided, into the pre-drilled holes. Use the Extended T20 Torx bit (D) provided. Check the frame is SQUARE.

IMPORTANT

The screws are a 'tight fit'.

So spray the threads with WD40 and insert in and out a few times, and use a low torque setting, to avoid stripping the screw head.

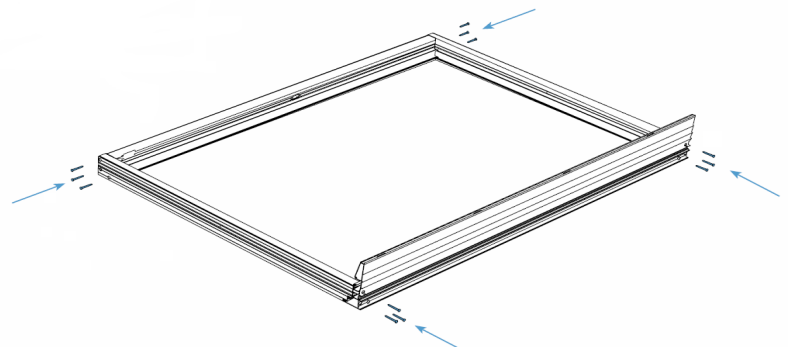

Assembling the frame continued

- 3 a.)** Apply Silicone sealant to the plastic cill end caps then fix to the ends of the cill using the 8mm (H) screws provided, into the pre-drilled holes.

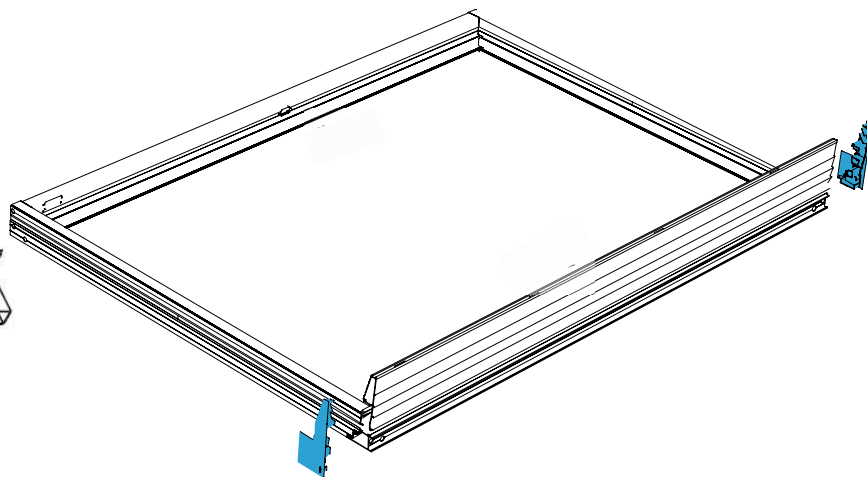
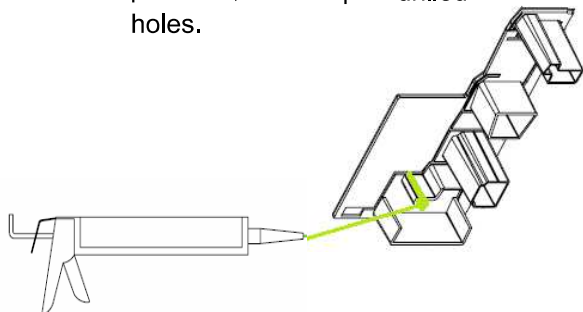

- 3 b.)** Apply a small bead of silicone sealant around the inside of the assembled frame joints to ensure no water ingress.

- 3 c.)** Remove the two loose cover plates from the Cill and put them on one side for later.

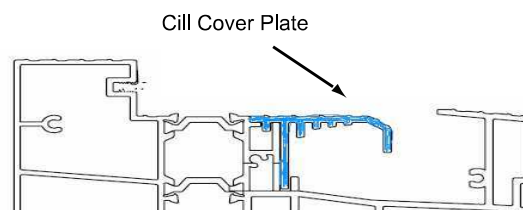

Opening options

Looking from the Outside towards the Inside:

OPEN OUTWARDS

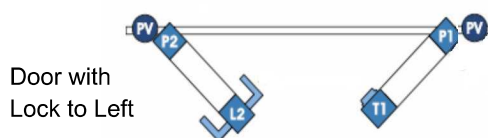

Door with
Lock to Left



Door with
Lock to Right.

OPEN INWARDS

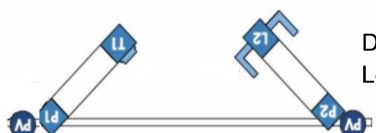

Door with
Lock to Right.

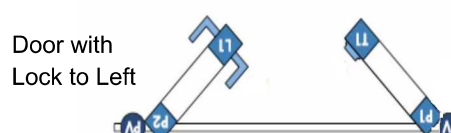

Door with
Lock to Left

For OPEN OUTWARDS options the raised rebate on the frame jambs, head and cill will be on the INSIDE.

For OPEN INWARDS options the raised rebate on the frame jambs, head and cill will be on the OUTSIDE.

Installing the assembled frame

- 4** Proceed to install the assembled frame ensuring that the cill faces to the outside.

The frame should be installed a minimum of 32mm back from the face of the brickwork, with the cill overhanging by no more than 15mm for drainage. It is critical that the frame is fitted square and level

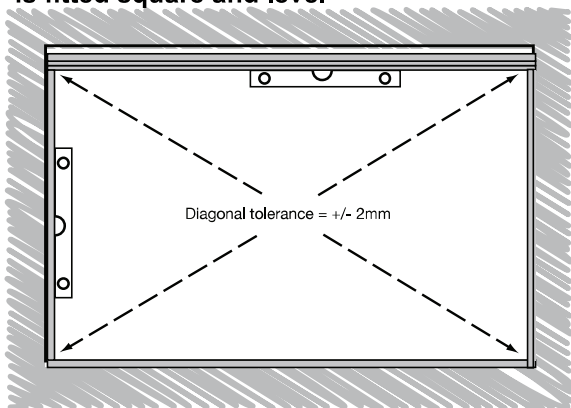

The diagonals must be the same, +/- 2mm

- 5** Use the 'Direct frame fixings' to secure the frame into the brickwork as follows:

- Locate the pre-drilled fixing holes in the head, cill and jambs. (Under the top and bottom keeps on the lock keep jamb) and through the 2 large holes in the centre keep, for additional security.
- Use the 6.5mm SDS masonry drill (C) supplied to drill through the pre-drilled frame holes, into the brickwork.

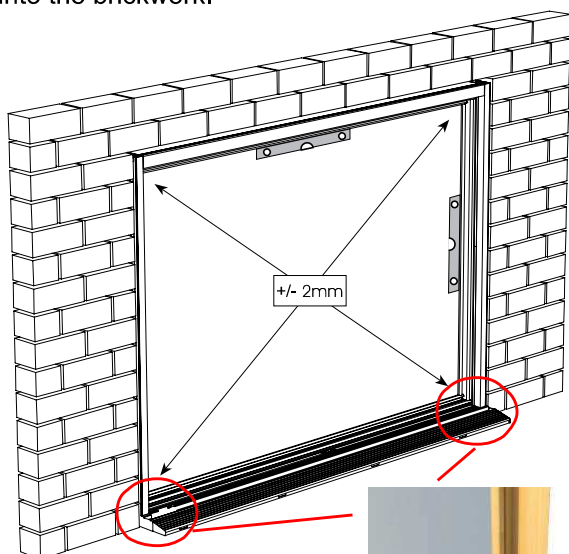

IMPORTANT NOTE

After the frame is installed, Silicone Seal around the base of the frame jamb/Cill joint as shown in the drawing

Use the packers and wedges provided to level the frame. Start at the Cill and insert the first packer **DIRECTLY UNDER THE FRAME JAMB** starting at the side of the frame which looks to be the lowest.

IMPORTANT NOTE:

The frame must be installed into the brickwork opening completely upright, square and level in every plane, before continuing with the installation. The door set uses a bottom rolling system so it is vitally important the cill is level and adequately supported by using packers and wedges, as necessary.

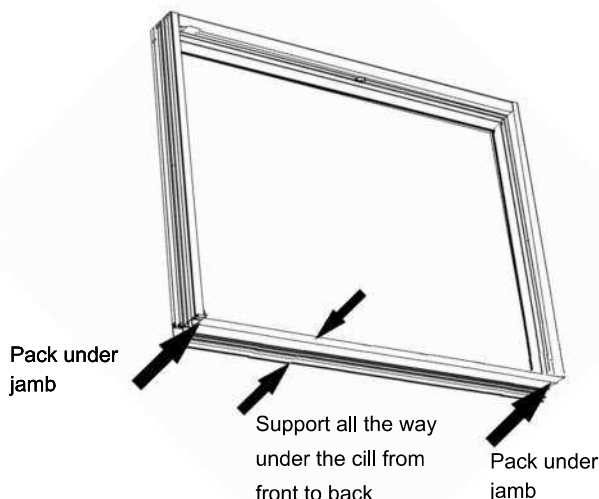

- Use the extended Torx T30 bit (E) supplied to screw the direct frame fixings through the frame into the brickwork, ensuring you do not overtighten the screws and distort the frame.
Use 92mm screws (A) to fix Head and Jambs.
Use 72mm screws (B) to fix the Cill
Use plastic frame fixing covers (H) to cover screw heads

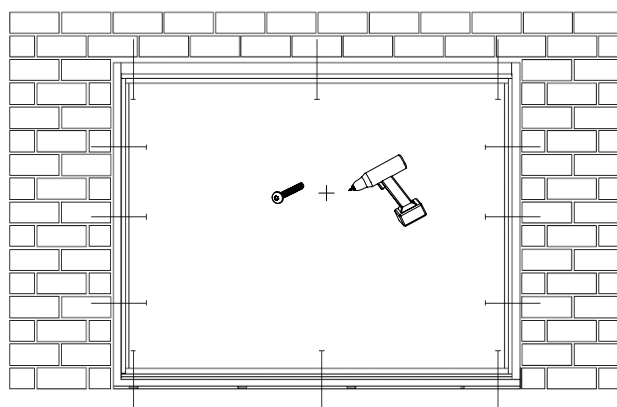

- 6** Check the frame one final time to ensure it is straight, level and square in every plane. When you are completely satisfied, use a chisel to remove any excess from the packers and wedges, then use expanding foam to fill the gaps between frame and brickwork. At the same time, remove any debris and dust from the Cill and top track.

IMPORTANT be very careful not to get expanding foam on the powder coated frame

Fitting the Door with Keeps

Note: Use the extended Torx T20 bit (D) provided, to fix all the hinges.

- 7a.)** Locate the door with keeps fitted, which already has the bottom pivot fitted. Ensure the Cill is protected by using the discarded foam door packing or cardboard to protect it and ensure that you have a support block to rest the door on. Also ensure the two loose metal Cill covers are removed from the Cill during assembly of the doors. (see drawing 3c)
- 7b.)** Lift the door with keeps and slide the pivot on the door over the pivot pin which is in the Cill. Please ensure the washer is in place on the pivot pin before lifting the door into position.

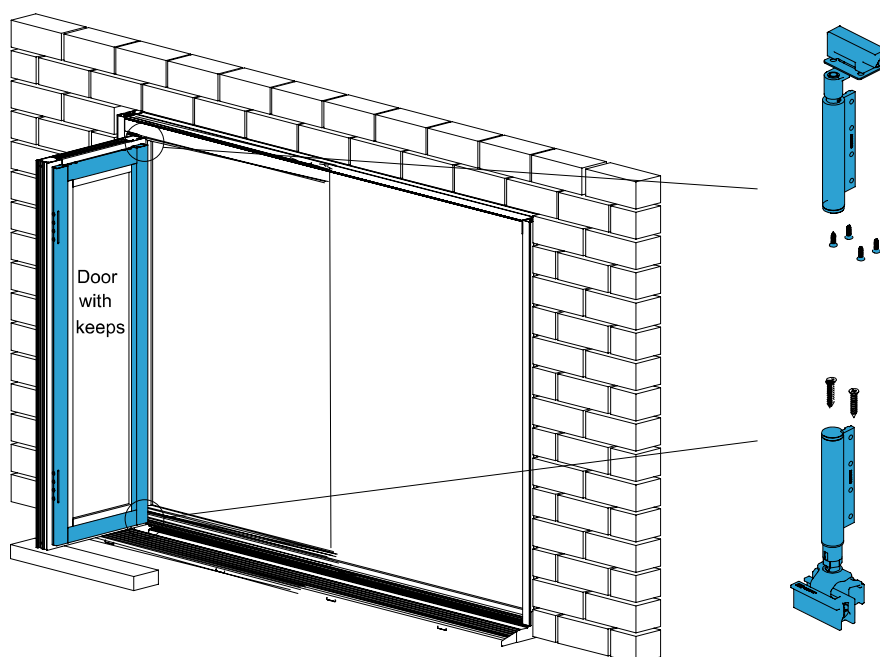

- 7c.)** With the door on the bottom pivot, slide the top pivot hinge onto the pivot pin in the frame head, then with the door at right angles to the frame, insert the hinge blade through the slot in the door, securing with the screws provided, in the pre-threaded holes.

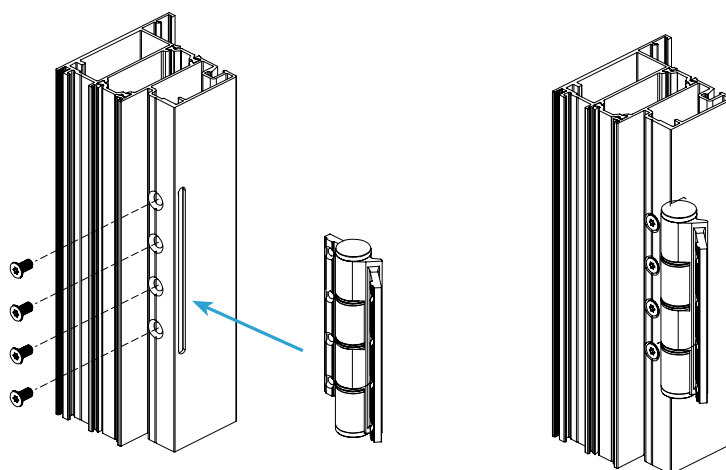

IMPORTANT: do not repeatedly open and close the doors without the track cover fitted at this stage.

Fitting the Door with the Lock

- 8** Fit the door with lock exactly the same as the door with keeps, see 7a, 7b and 7c.

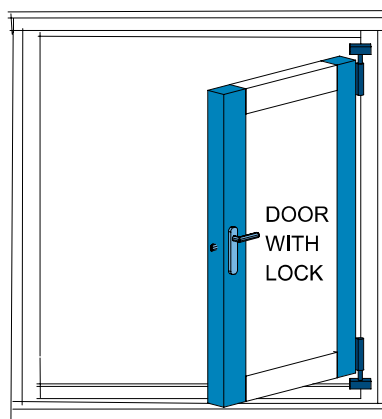

Top and Bottom Keep adjustment

- 9** An in-out compression adjustment of the keeps can be made by rotating the large top and bottom adjusters, using the T15 Torx bit (F) provided.

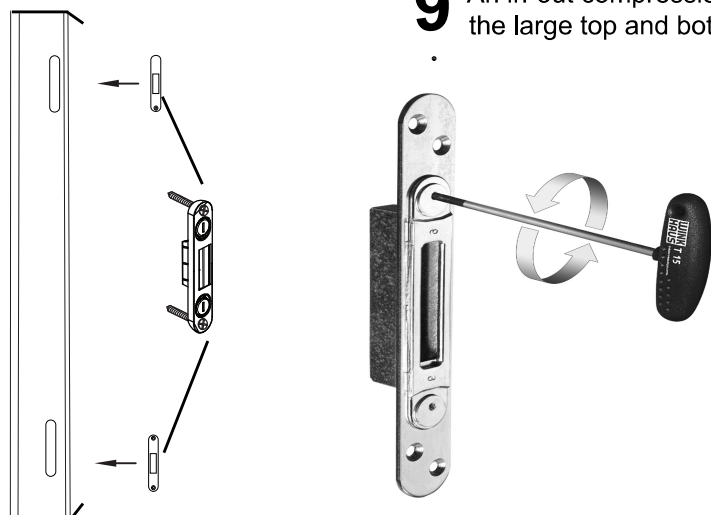

Fitting the handle

10

- a)** Fitting spindle assembly.
Insert the spindle end into the exterior handle.
Insert euro cylinder lock and secure with screw provided.
Secure the handles with the screws provided.
- b)** To operate the lock, lift the handle fully upwards to engage the lock bolts, then let the handle return to centre and turn the key to lock.
To unlock, turn the key and depress the handle.

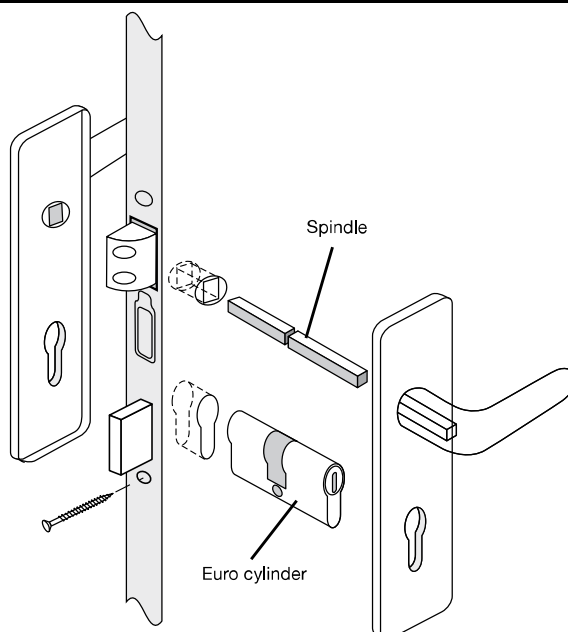

Operation of the Aluminium French Doors

11

Do not operate the doors without the track cover fitted to the bottom cill.

When closing the door set, first close the door with keeps, securing it with the twin point lock, by turning the handle 180 degrees so the door then locks.

Then close and lock the other door by lifting the handle and turning the key.

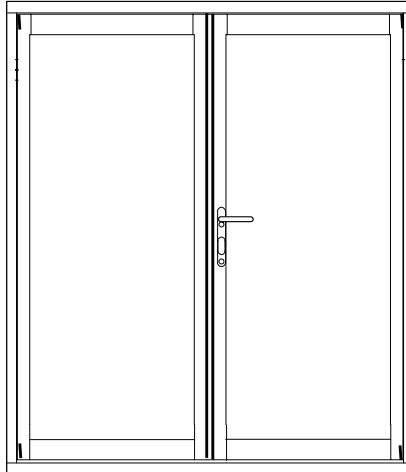

To open the doors, unlock the door with handle by using the key, then depress the handle to open the door.

To open the other door pull the twin point lock handle towards you then rotate it 180 degrees and push the door open.

Adjusting the French Door height

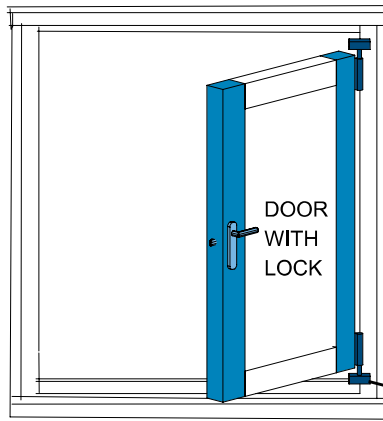

- 12** The door height can be adjusted up or down by adjusting the bottom pivot on both doors. Total height adjustment is +/- 8mm. The door height should be adjusted so the space at the top and bottom of the door are even, the doors are operating smoothly and not catching on the cill and the lock operates correctly.

a.

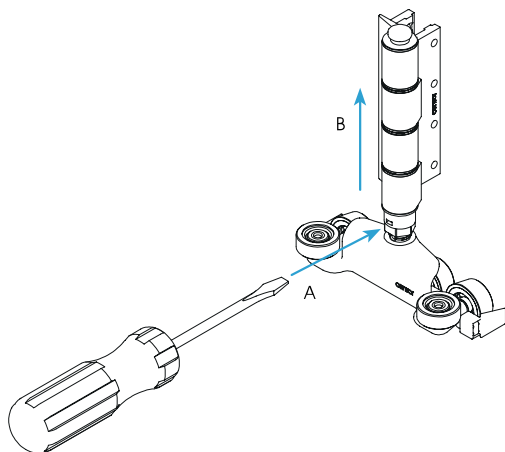

b.

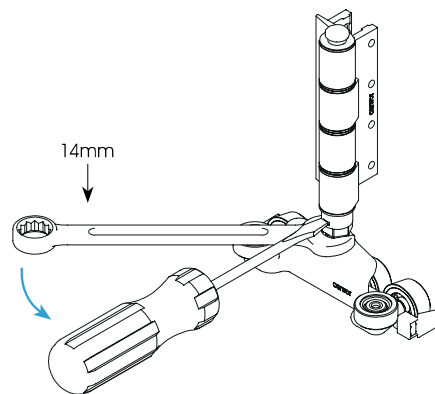

c.

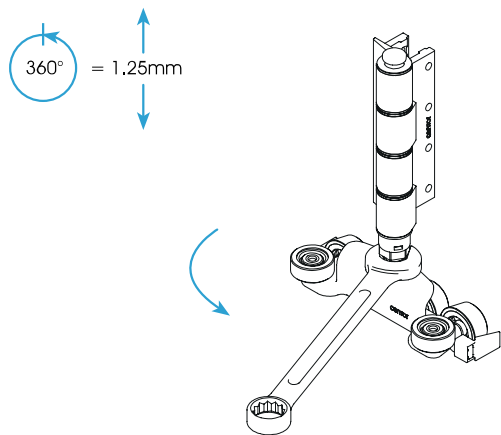

d.

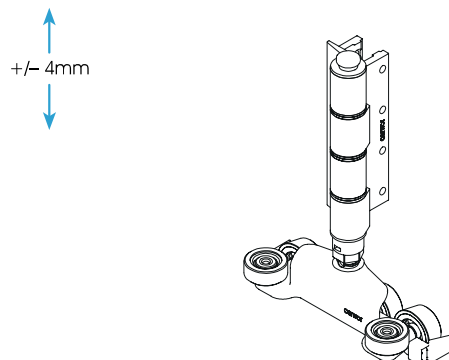

Adjusting the door set width

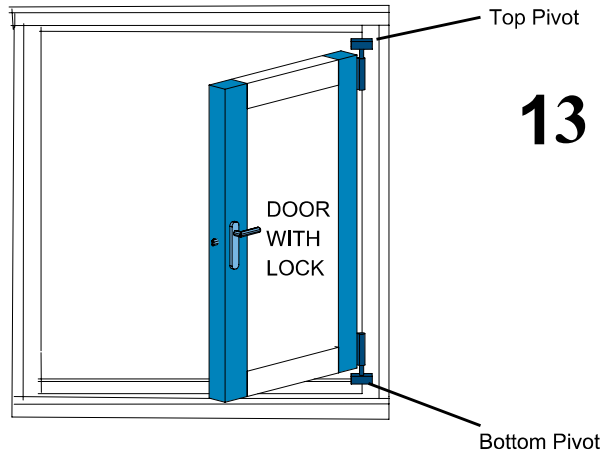

13

The doors can be adjusted in width by up to 10mm. The standard spacing should be +/- 4/5mm between the left and right doors. To move the doors left or right, with the doors in the fully open position adjust the top and bottom pivots, as shown in a.

a.

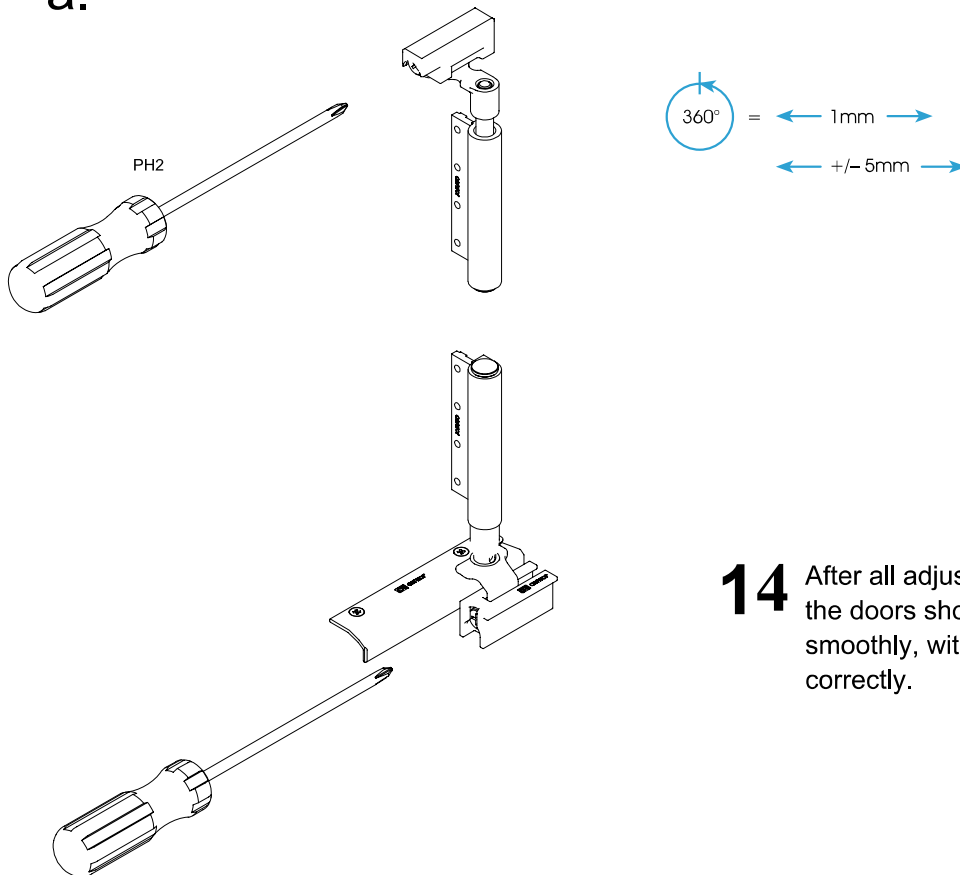

14

After all adjustments are complete, the doors should open and close smoothly, with the lock operating correctly.

Declaration of Performance

DoC №: JCI/FSDFD70D

Product Type: **Vufold Supreme** Folding Sliding / French Double Glazed Door
Intended Use: Non escape route door
Conformity System: Assessment and verification of constancy and performance
Provision to which the product performs: EN 14351-1:2006+A1:2010

Declared Performance:

Essential Characteristics

Performance

Resistance to Wind Load:	Class A3
Watertightness:	Class 7A
Dangerous Substance:	No emissions of dangerous substance emitted
Load Bearing Capacity of Safety Device:	Npd
Acoustic Performance	Npd
Thermal Transmittance:	1.7w/(m²K)
Radiation Properties:	Npd
Air Permeability:	Class 2

The performance of the product identified is in conformity with the declared performance.
This declaration of performance is issued under the sole responsibility of
Centor Central Europ SP. Z O.O.
Signed for on behalf of the Company by:

.....

Peter Watkins, General Manager
Solihull, 1 December 2014



BS EN 14351-1:2006+A1 2010 13

Vufold Supreme C1

Declaration of Performance

DoC №: JCI/FSDFD70T

Product Type: **Vufold Supreme** Folding Sliding / French Triple Glazed Door
Intended Use: Non escape route door
Conformity System: Assessment and verification of constancy and performance
Provision to which the product performs: EN 14351-1:2006+A1:2010

Declared Performance:

Essential Characteristics

Performance

Resistance to Wind Load:	Class A3
Watertightness:	Class 7A
Dangerous Substance:	No emissions of dangerous substance emitted
Load Bearing Capacity of Safety Device:	Npd
Acoustic Performance	Npd
Thermal Transmittance:	1.5w/(m²K)
Radiation Properties:	Npd
Air Permeability:	Class 2

The performance of the product identified is in conformity with the declared performance.
This declaration of performance is issued under the sole responsibility of
Centor Central Europ SP. Z O.O.
Signed for on behalf of the Company by:

.....

Peter Watkins, General Manager
Solihull, 1 December 2014



BS EN 14351-1:2006+A1 2010 13

Vufold Supreme C1